

DO NOT SCALE FROM THIS DRAWING, USE FIGURED DIMENSIONS ONLY.

ALL DIMENSIONS TO BE CHECKED ON SITE PRIOR TO ANY COMMENCEMENT OF WORK AND ANY OMISSIONS/ERRORS TO BE REPORTED TO THE ARCHITECT.

THIS DRAWING IS TO READ IN CONJUNCTION WITH ALL RELATED ARCHITECTS AND ENGINEERS DRAWINGS AND ANY OTHER RELEVANT INFORMATION.

THE COPYRIGHT OF THIS DRAWING IS VESTED WITH HARRIS IRWIN ASSOCIATES AND MUST NOT BE COPIED OR REPRODUCED WITHOUT THEIR WRITTEN CONSENT.

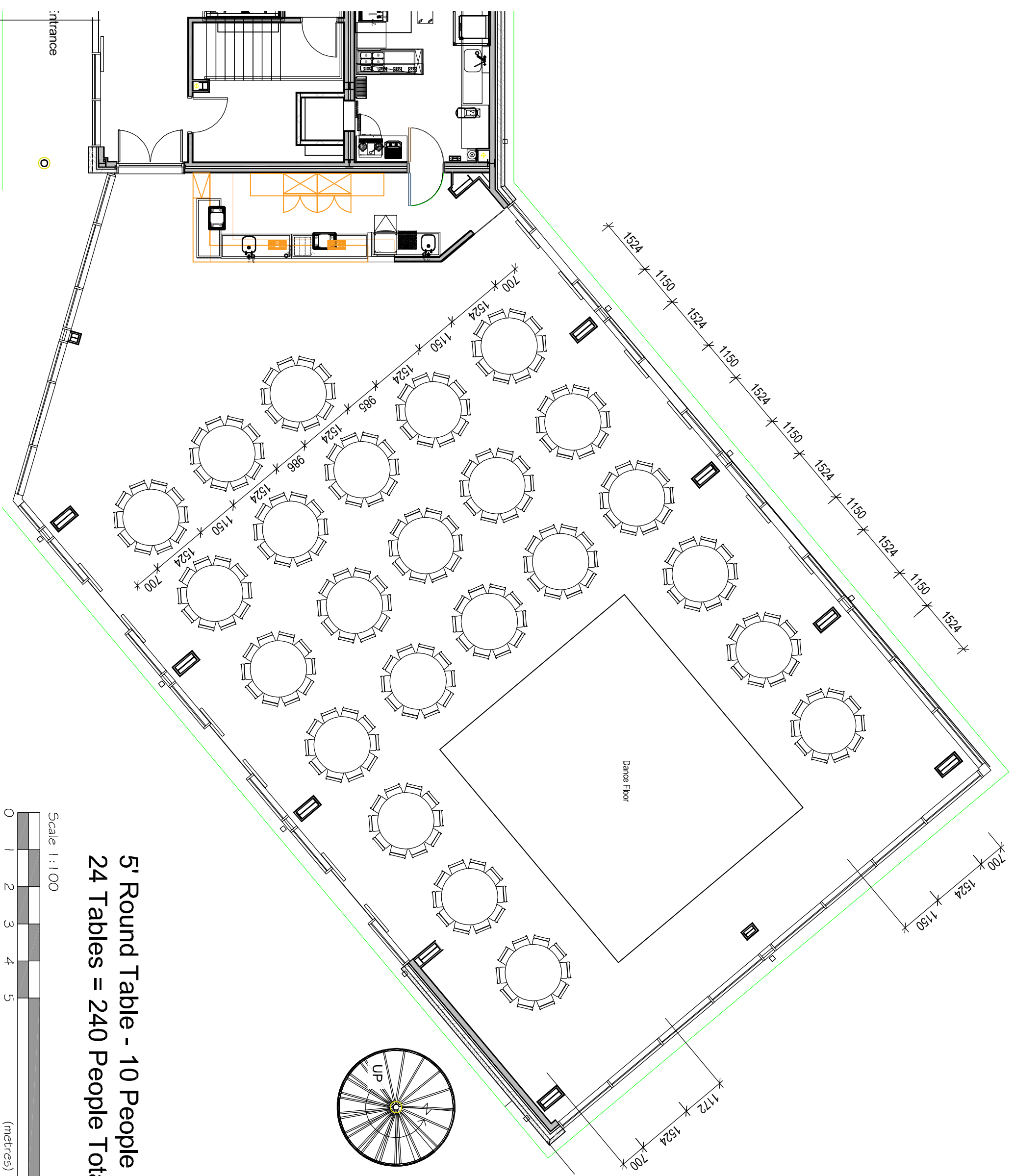

**5' Round Table - 10 People**  
**24 Tables = 240 People Total**

Scale 1:1100

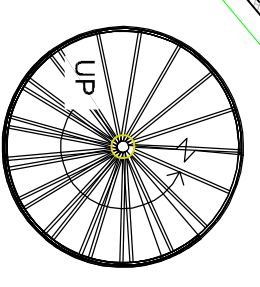
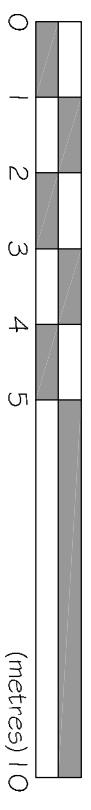

Rev	Date	Comment	By

**harrisirwin**  
 architects & designers

ASKE STABLES, ASKE, RICHMOND  
 NORTH YORKSHIRE DL10 5HG  
 t : 01748 825675  
 e : enquiries@harrisirwin.com  
 w : www.harrisirwin.com

**Project:**  
 New Owners and Trainers Facility  
 Thirsk Racecourse  
 Thirsk

**Client:**  
 Thirsk Racecourse

**THIRSK RACECOURSE**  
 YORKSHIRE RACING & EVENTS

**Drawing:**  
 Table Layout - 5' Rounds

**INFORMATION**

<b>Scale @ A3</b>	<b>Date:</b>	<b>Drawn:</b>	<b>Checked:</b>
1:100	Nov 2017	KTC	
<b>Proj. No.:</b>	<b>Status:</b>	<b>Dwg. No.:</b>	<b>Rev No.:</b>
2194	CO	(70) 7007	.