

DO NOT SCALE FROM THIS DRAWING, USE FIGURED DIMENSIONS ONLY.

ALL DIMENSIONS TO BE CHECKED ON SITE PRIOR TO ANY COMMENCEMENT OF WORK AND ANY OMISSIONS/ERRORS TO BE REPORTED TO THE ARCHITECT.

THIS DRAWING IS TO READ IN CONJUNCTION WITH ALL RELATED ARCHITECTS AND ENGINEERS DRAWINGS AND ANY OTHER RELEVANT INFORMATION.

THE COPYRIGHT OF THIS DRAWING IS VESTED WITH HARRIS IRWIN ASSOCIATES AND MUST NOT BE COPIED OR REPRODUCED WITHOUT THEIR WRITTEN CONSENT.

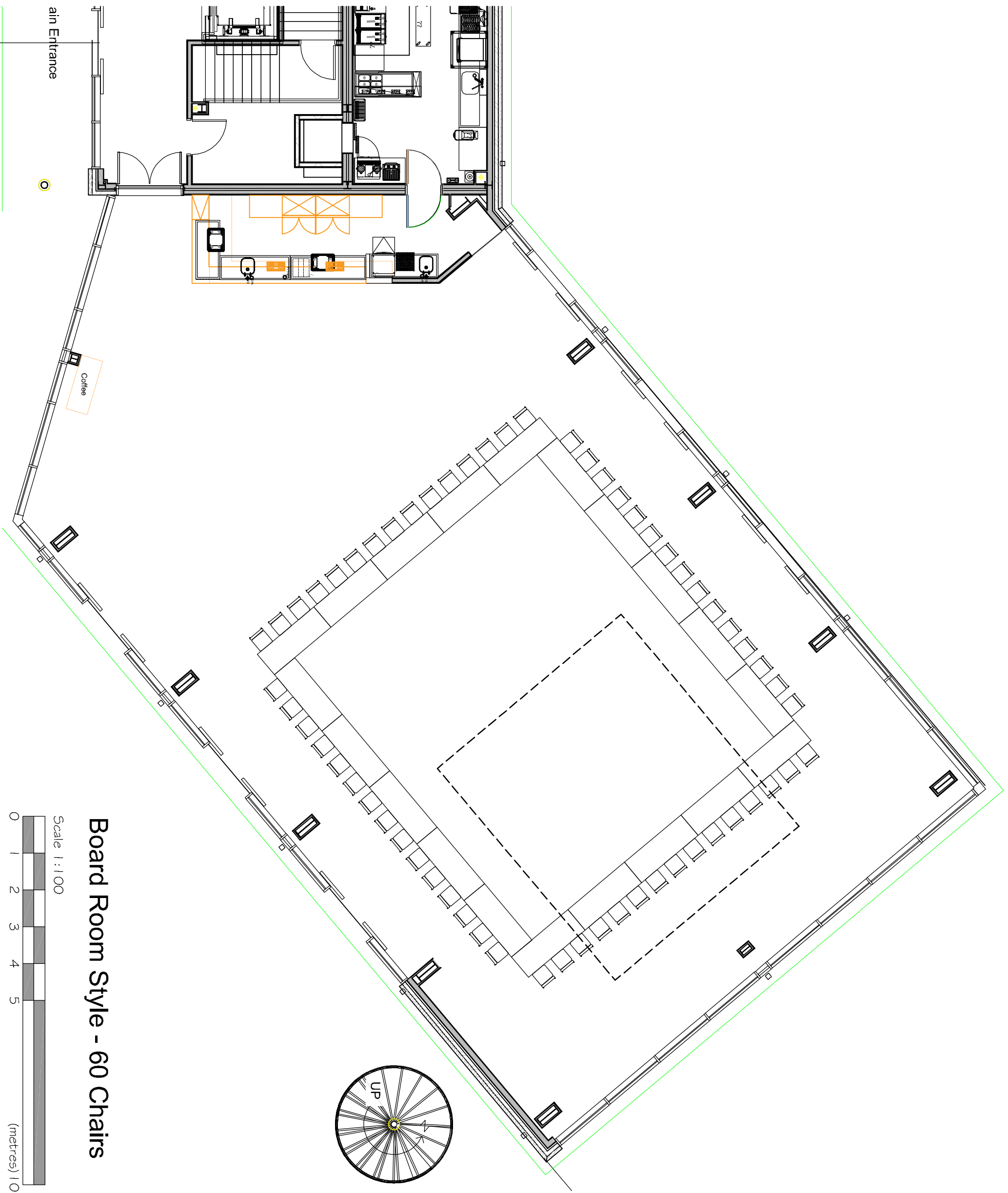

Board Room Style - 60 Chairs

Scale 1:100

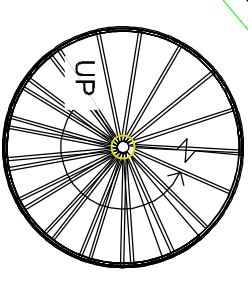
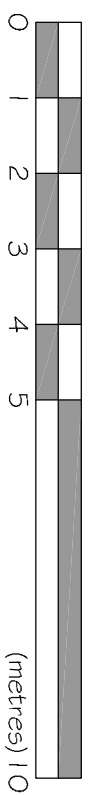

Rev	Date	Comment	By

harrisirwin
architects & designers

ASKE STABLES, ASKE, RICHMOND
NORTH YORKSHIRE DL10 5HG
t : 01746 825675
e : enquiries@harrisirwin.com
w : www.harrisirwin.com

Project:
New Owners and Trainers Facility
Thirsk Racecourse
Thirsk

Client:
Thirsk Racecourse



THIRSK RACECOURSE
YORKSHIRE RACING & EVENTS

Drawing:
Table Layout - Board Room

INFORMATION

Scale @ A3	Date:	Drawn:	Checked:
1:100	Feb 2018	KTC	
Proj. No.:	Status:	Dwg. No.:	Rev No.:
2194	CO	(70) 7011	.